

SHELVING HARDWARE

We stock the Knap & Vogt line of cantilever shelving hardware. The 80 series is steel, with one inch adjustments; with the last two digits being the length in inches. Standards are 5/8" wide, by 13/32" high. Sold individually without screws.

<u>ANACHROME</u> length/inches v	<u>WHITE</u>
KV80AN024	
KV80AN036	
KV80AN096	KV80WH84

(other lengths, and colors, available by special order)



If any of the above standards are to be used in a showcase where they cannot be screwed to a backing, use the 137 to support the top of the standard, the 136 at the bottom.

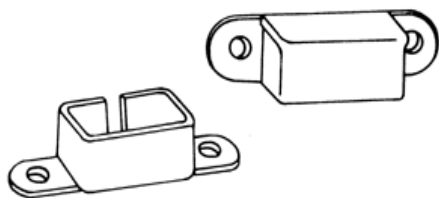

KV136 **KV137**

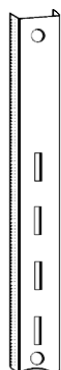
**KV83ANO84**

If a heavier weight standard is preferred for medium weight loads, the shown 83 is also suitable for 1" adjustable brackets, width 3/4" x 1/2" high. Sold individually.

Use TBSI to anchor 80 standard screw in dry wall.

These brackets fit any 1" adjustment KV standard.



<u>ANACHROME</u> length/inches v	<u>WHITE</u>
KV180AN06	
KV180AN08	
KV180AN010	
KV180AN012	
KV180AN014	
KV180AN016	
KV180AN018	
KV180AN020	

KV's Suggested Max.
Load/Bracket on 16" centers
not rated

160

120

95

100

95

80

60

KV180WH10d
KV180WH12

(other colors available by special order)

For commercial installations, or children's rooms, the lock-nut bracket 160 will keep the bracket from falling out of the standard, and so prevent the shelf



from falling. **KV160ANO12**

For magazine racks, or to permit an above eye-level shelf to become a display shelf, use a slant adjustable bracket. Bracket adjusts to 15, 30, and 45 degree angles.

KV179ANO12 **KV179ANO14**

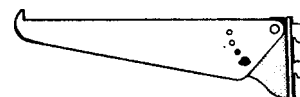

If a glass shelf is being mounted on the bracket, a plastic shelf rest **KV104P** should be press-fit over the bracket and the **KV129** rubber cushion pressed into the holes in the shelf rest. If an almost totally clear cushion is desired, use **1/16BUMPER** (a 1/16" thick by 3/8" diameter, self-adhesive silicone pad) to press onto the shelf rest. Either way, the glass is held away from the steel bracket, thereby avoiding scratches from the movement of the glass due to building vibrations.

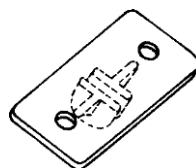

KV104P

KV129



1/16BUMPER



For heavier weight installations, use the 85 series double slotted standards (measuring 1-1/4" wide, 1/2" high) and brackets. Since these are also 1" adjustable standards, all of the 180, 179, and 160 brackets may be used, in addition to the double pronged 185 bracket. Standards are sold individually shipped without screws.

<u>Part Number*</u>	
<u>Anachrome</u>	<u>White</u>
KV85ANO24	
KV85ANO36	
KV85ANO48	
KV85ANO60	
KV85ANO72	
KV85ANO84	KV85WH84
KV85ANO96	

*(last 2 digits = length in inches)



<u>Part Number*</u>		KV's Suggest Max. Load/Bracket on 16" Center
<u>Anachrome</u>	<u>White</u>	
KV185ANO10		285 lbs.
KV185ANO12	KV185WH12	260 lbs.
KV185ANO14	KV185WH14	240 lbs.
KV185ANO16	KV185WH16	220 lbs.
KV185ANO18	KV185WH18	190 lbs.
KV185ANO20		180 lbs.
KV185ANO22		160 lbs.
KV185ANO24		160 lbs.

*(last 2 digits = length in inches)

SHELF BRACKETS may be used as supports or as braces. Gray paint. These are the heaviest duty, for the price, brackets we have ever seen. Sold individually, no screws.

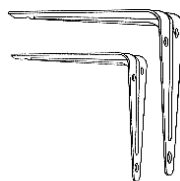

<u>Part Number</u>	<u>Size in Inches</u>
10X12BRACKET	10x12x1-13/16
12X14BRACKET	12x14x1-7/8

Knap + Vogt's heaviest duty standard is the 87 series, measures 7/8" wide x 11/16" high, and having 2" adjustment. Standards are stocked as follows, no screws.

<u>Part Number*</u>	
<u>Anachrome</u>	<u>White</u>
KV87ANO24	
KV87ANO36	
KV87ANO48	
KV87ANO60	
KV87ANO72	
KV87ANO84	KV87WH84
KV87ANO96	

Only 2" adjustable brackets may be used on the 87 series standard.

<u>Part Number*</u>		KV's suggested Max. Load/Bracket on 16" centers
<u>Anachrome</u>	<u>White</u>	
KV186ANO8		
KV186ANO10		380 lbs.
KV187ANO12	KV187WH12	530 lbs.
KV187ANO14	KV187WH14	455 lbs.
KV187ANO16	KV187WH16	360 lbs.
KV187ANO18	KV187WH18	270 lbs.
KV187ANO20		385 lbs.
KV187ANO22		310 lbs.
KV187ANO24		270 lbs.



*(last 2 digits = length in inches)



<u>Part Number*</u>	
<u>Bracket</u>	<u>Standard</u>
HBBRACKET12	XNP24
HBBRACKET14	XNP36
HBBRACKET16	XNP48
19XNP18**	XNP60
	XNP72
	XNP84

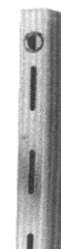

*(last 2 digits = length in inches)

** (has plastic locking clip)

When performance and price are important, but name is not, consider our house brand heavy-duty shelving standards and brackets in satin zinc finish.

Heavier (by weight) than competition, interchangeable with the competition, AND with a 20% cost savings.

Our brackets feature an all steel lock.

They and the standards are stamped from 1/8" thick cold rolled steel.

Standards have 1" slots on 2" centers.

The 187-186 brackets do not have a flange to hold the shelf into place. The 210 and 211 saddle the bracket and are screwed into a pre-drilled hole with a machine screw (provided). **6x1/2PHZP** wood screws are then driven from the bottom into the shelf. These saddles are usually used at the front and back of the bracket to keep the shelf level and to prevent tipping. The 210 is



CS211

used on an end bracket if the shelf does not project sufficiently beyond the bracket to cover the 211. **CS211** is our house brand which twists into the bracket receiving hole, and then is locked into place by either the weight of the shelf, or a screw driven into the shelf.



KV211



KV210

SHELVING TRACK (OR STANDARDS)

The 255 series track measures 5/8" wide by 3/16" high, and is designed to fit into a kerf, or may be surface mounted. This track may be stapled, nailed or screwed (order **4X5/8__SCREWS**. (A #6 pan head will fit in the predrilled holes, but clips will not fit over the head.)

Length, in inches, is last two digits in part number.

clear aluminum plate

CS255AL18d

steel, white plate

KV255WH96

steel, brown

KV255BRN96

steel, zinc plate

KV255ZC96

steel, brass plate

KV255BR36
KV255BR48d
KV255BR96



The **KV757** will hold 1-1/16" or 1" hang rod.

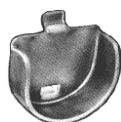

SHELF SUPPORTS

Shelf support, in steel with the appropriate finish. If a glass shelf is going to be supported with a 256, also order **.085CLEAR** (a 1/16" thick, selfadhesive pad that press applies to the surface of the clip to cushion the glass). Our steel clips rated at 60 lbs. per clip (vs. aluminum at 40 lbs./clip).

our part number

CS256BR

CS256BRN

CS256ZC

CS256WH

color

brass

brown

zinc

white

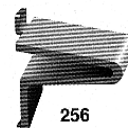

256

Shelf supports for pre-drilled holes as shown are steel with respective plating. If finishing of the case is done after drilling, expect the hole sides to be slightly covered with finishing products, effectively reducing the diameter of the hole.



SPOON TYPE SUPPORTS

<u>Shank</u>	<u>Plating</u>	<u>Stock Number</u>	<u>Packing</u>
1/4"	BRASS	1/4SPBP	100/pk
1/4"	NICKEL	1/4SPNP	100/pk
5mm	BRASS	5MMSBPBC	100/pk
5mm	BRASS	5MMSBPBM	2000/pk
5mm	NICKEL	5MMSPNPC	100/pk
5mm	NICKEL	5MMSPNPM	2000/pk

SPOON TYPE SUPPORTS WITH SLEEVES

<u>Shank Dia.</u>	<u>Plating</u>	<u>Stock Number</u>
7mm	brass	7MMSBPB
7mm	nickel	7MMSPNP

<u>Sleeve Dia.</u>	<u>Plating</u>	<u>Stock Number</u>
7.5mm	brass	7.5MMBPSL
7.5mm	nickel	7.5MMNPSL

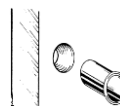

The Swedish shelf support is intended to be mounted into 5mm pre-drilled holes. The edge of the shelf is kerfed almost to the front edge. When installing the shelf, it slides over the support, covering it from top, bottom, and front, making for an invisible support. Length - 224mm, c-to-c. Nickel plate steel. **SWEDESHelf** 3/16" (5mm) thick

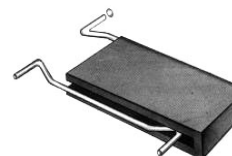

5MMLOCK – 5MM pin, nylon screw locks shelf up to 3/4" projection, 3/4" width, chrome plate

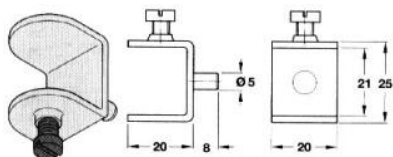

	<u>Pin Dia.</u>	<u>Pin Length</u>
KV335TAN	1/4"	7/16"
KV335CLEAR	1/4"	7/16"
Shelf rest - 1/2" x 17/32"		



ELBOW SUPPORTS

<u>Dia. of Shank</u>	<u>Plating</u>	<u>Stock No.</u>
1/4"	Brass	CS346BR
1/4"	Nickel	CS346NP
1/4"	Bronze	CS346BRNZ

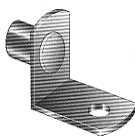

BLADE TYPE SUPPORTS

The **KV333** is intended to be installed either under the shelf, or like the Swedish shelf support shown at left, in a kerf in the side of the shelf.

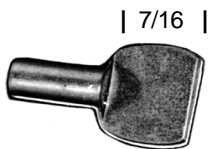

<u>Shank Dia.</u>	<u>Plating</u>	<u>Stock Number</u>
15/64"	Nickel	KV333

PLASTIC SUPPORT, STEEL SHANK

<u>Shank Dia.</u>	<u>Color</u>	<u>Stock No.</u>
5mm	White	5MMWP
5mm	Clear	5MMCP

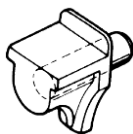

Shank Dia. - 5mm
Mat. Thickness - 5/8"
Color - White
Stock No. - **WH5/8LOCK**

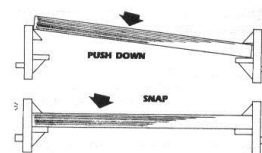

CLOSET STORAGE AIDS



White colored rod and shelf support is a heavy duty, wrought steel support, provided with installation screws. It will support pole up to 1-1/2" diameter. Sold individually, no screws.

CS1195

This rod and shelf support bracket may be mounted to a hook strip. Supports poles up to 1-3/8" in diameter. Sold individually, no screws.



Stock No.
CS1194ANO
CS1194

Color
Anochrome
White

Nicely plated aluminum. 25 in a box, also sold individually.

COATWALLBP - brass
COATWALLNP - nickel



3" Proj.

Nicely plated aluminum. 25 in a box, also sold individually.

COATWALL2DC - Dull Chrome



Nicely plated aluminum. 25 in a box, also sold individually.



2 1/4" Proj.

COATCEILBP - brass
COATCEILNP - nickel



5-3/4" x 3" projection
CS2038

Our tubing is 2mm thick, polished chrome finish.
Available in both 1-1/16" and 1-5/16" diameters.

Length in Inches

v

11/16PIPE96
11/16PIPE144
15/16PIPE96
15/16PIPE144



CS660 tubing is stainless steel clad.

Length In Inches

v

CS66011/1696
CS66011/16144

KV 660 brass-look tube has 13 gauge (.087") steel walls and is available in 1-1/16" diameter.

Length in Inches

v

KV660BR144

Twelve foot may be cut to size (to meet U.P.S. shipping requirements).

1-1/16" tube can be installed in the shown flanges. The "O" flanges provide the most security, in that the rod cannot be jarred loose and is more difficult to install as screws are tightened with the rod in place. The "U" flange is installed before the rod is in place, and is therefore an easier installation.

CS734NP 1-1/16" mat. **CS735NP**
KV734BR **KV735BR**

Each socket uses 2-8X3/4- screws.



KV632NP is used for 1-1/16" hang rod in conjunction with predrilled 5mm holes on 32mm centers. Has 2 pegs in 32mm and second hole for flat head screws.



CS766
6X3/4PHZP screws

1- 5/16" mat. **CS764**uses 3-
uses 3-8X3/4ZP screws



Our oval pipe is chrome plated
30x15x1x96

Stock no: **30PIPEOVALCP**



Use **PIPEOVALU** 30mm flange for the oval pipe.

For home installations, or light duty commercial installations, the KV2 series of adjustable and a quality bright zinc appearance. Stocked in all sizes shown, with minimum and maximum lengths as shown. 72" and 96" include intermediate supports.

KV2ZC30 expands to 48"
KV2ZC48 expands to 72"
KV2ZC72 expands to 120"
KV2ZC96 expands to 144"



Older houses frequently have closets too small to accept today's coat hangers. To remedy that situation, these hangers mount to the underside of the back of the closet, much like a drawer slide. Packed in poly-bags, with all screws enclosed. **KV1NP16**



For applications where space and economy are important, install this three-bar towel rack, 18" L x 5" W, anochrome finish. Side mounts (with four screws) to either left or right hand side of the cabinet. **CS793**

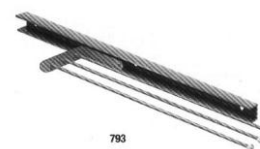

The **KV320** table top fastener is 12 gauge steel, 1" wide, uses #8 pan head screws. The **KV1547** desk top fastener is 12 gauge steel. Both designed to firmly secure the applicable top to its base, while permitting expansion resultant from humidity changes.

**KV320****KV1547**

The **KDFITTINGKEY** is mortised into the back of a picture frame or shelving unit. The **KDFITTINGKEY** then is slipped over the head of a #12 round head screw (not provided) and therefore there must be room mortised for a screw head to project into the unit. The wedge shape provides a pressure fit against the screw. Plate is 5/8" x 1-3/4" x .125".



The Giro-Bolt Lock provides rapid and extremely stable connections, ideal for conference tables, folding and sliding partitions. The hook shaped bolt is turned by means of the double Allen key. The bolt grips under the striking plate and holds the mounted element solidly together by tightening. The bolt cannot be released without a key. All hardware is steel finish, except for the bright solid brass covering sleeve. Each piece shown is sold individually, using the following part numbers

GIROPLATE
GIRO

GIROKEY
(1 req'd. per job site)

GIROSLEEVE
(not required)

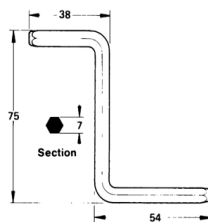

TOGGLER TOGGLE BOLT - hollow wall anchor

For critical, "can't miss" performance. When holding power must be strong and secure.

Our TOGGLER brand toggle bolt features a one-piece steel anchoring channel which pivots on the durable installation legs. The sliding cap zips down the legs to securely "capture" the wall between the channel and the cap. The legs snap off easily, flush with the wall. Place item to be attached, insert bolt and tighten flush for easy, reliable anchoring.

Easy to use - Pre-install without bolt and in smaller hole.

Strongest toggle bolt available - size for size.

.Accurate - Rugged pre-installation mechanism centers and holds in place the toggler bolt in a small hole before inserting bolt.

Fast -Install with a screw gun or regular screw driver.

Convenient - Enable removal of bolt/fixture without anchor falling behind wall.

Safe + reliable -Will not damage or break through wall even under vibratory load.

Grips wide range of material -from 3/8" to 2-1/2" in thickness.

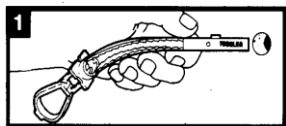

1. Drill appropriate size hole. Hold metal channel flat along-side plastic straps and slide channel through hole.

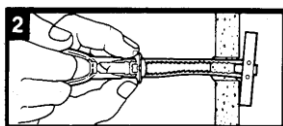

2. with one hand, pull ring so metal channel rests flush behind wall, as you slide plastic cap along straps with other hand until flange of cap is flush w/ the wall.

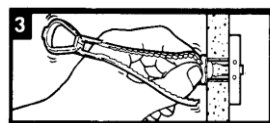

3. Place thumb between plastic straps. Push side to side snapping off straps at wall.

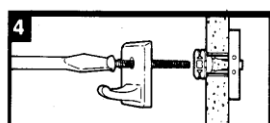

4. Insert bolt through item to be attached and tighten Until flush with wall. Minimum clearance behind wall: 1-7/8".

ORDER INFO & PULL-OUT VALUES

Stock No.	Qty/ box	Uses bolt	5/16" Drywall	M A T E R I A L S	
				Concrete 1/2" Block	Steel Plate
BB	100	1/4"-20	306 lbs.	925 lbs.	1,283 lbs.

PICTURE HOOK / WIRE ANCHORS

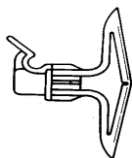

Hanging wall decor has never been this simple. **TH** anchors have their own built-in hook for hanging pictures, mirrors, or anything with a wire or staple to be hooked. Anchor is suitable for stringing telephone cable, household electrical wire and stereo cable.

Use without a screw for light applications (less than 10 lbs.) in 3/8" - 1/2" thick walls. The convenient plastic lip guides the picture wire into place for an added measure of safety.

- Holds three times (3X) more than old-fashioned nail-in metal picture hooks when used with screw.
- Design puts load directly on screw for maximum reliable holding power.
- Corrosion-proof for hanging fixtures in humid areas.
- Works in hollow, thick, and solid walls.
- Safe load rating is 40 lbs. per anchor, when used with a screw.

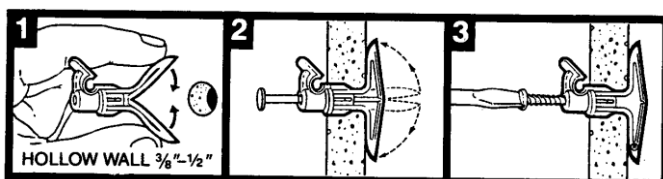

Drill a 5/16" (8mmØ) hole. Insert red key to pop anchor open behind wall (unnecessary in thick or solid walls). Do not force or hammer key.

Insert screw and tighten until flush with hook anchor. Use any sheet metal screw from No. 6 (3.5mmØ) With a minimum length of 1-1/2" (38mmØ).

Minimum wall grip range: 3/8" - 1/2"
 Minimum screw length: 1-1/2"
 Screws size (diameter): 6 through 14
 Minimum solid wall hole depth: 1-1/4"
 Order stock number: **TH**
 Packing: 100/box



For walls 1/8" to 1/4 thick - use Extra Short

For walls 3/8" to 1/2 thick - use Short

For walls 5/8" to 1-1/8 thick - use Long

For walls 1-1/4" to 1-3/4 thick - use Extra Long

SHH – Slotted Hex Head

How To Use Rawly Hollow Wall Anchors

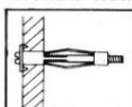

1. Drill proper size hole and insert Rawly. Tap head of Rawly until prongs are embedded in wall.

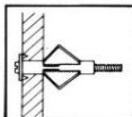

2. Turn in screw until a definite resistance is felt. This indicates the Rawly is set.

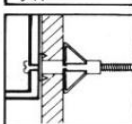

3. Remove screw. Place object to be fastened in position and tighten screw.

Wires, Tubing, PVC Pipe... Get a grip on a mess of wires with Toggler WIRE HARNESS ANCHORS

This unique device is more than just an anchor...it's an organizer. Wire bundles, cables, small PVC pipes are held snugly and securely to the wall...out of harm's way, eliminating unsightly wire tangle. With integrated, adjustable, insulative, plastic strap and lock for light-duty use in hollow walls without a screw, and heavy-duty use in any substrate with a screw.

- Eliminates need for a separate tie-wrap, attachment clip, and fastener
- Absorb vibration and shock
- Ideal for electrical and marine installation
- Perfect in harsh chemical environments -corrosion free.

WIRE HARNESS ANCHORS: 6" X 5/16" strap which can be used in two ways.

- with 18 centered locking positions when installed for use without screw.
- holding diameter range 0.3-1.5" (8-38mm) without screw.

- with 20 side locking positions when installed for use with screw
- holding diameter range 0.1-1.3" (3-33mm)

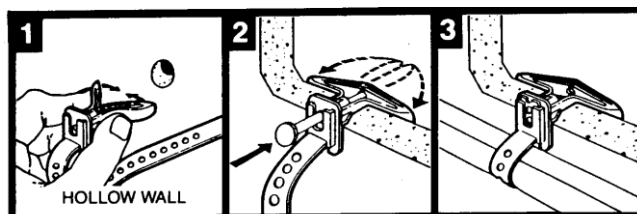
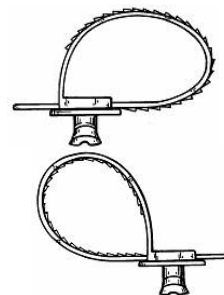

Drill 5/16" (8mm) hole. Fold wire harness anchor, insert anchor in hole and tap flush with wall.

Insert key* to pop anchor open behind wall (except in thick or solid walls). **Do not hammer key. Remove key.**

Place harness around wire as shown in fig. 3 and pull tip through slot until tight.

EASY INSTALLATION

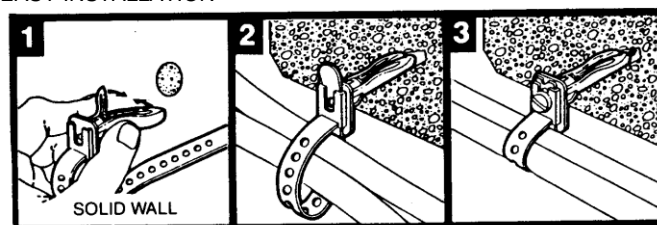

In solid walls, or hollow walls where extra support is required, place screw through hole in harness and into anchor, then tighten flush with anchor.

Stock No.	Min. wall grip range	Min. screw length	Min. hole depth in solid wall
TBWH	3/8"-1/2" (9-13mm)	1-1/2" (38mm)	1-1/4" (32mm)
TCWH	5/8"-3/4" (16-19mm)	1-3/4" (44mm)	1-1/2" (38mm)

All sizes use #6 - #8 screws. Packing = 50/box including 3 keys.

PANEL HANGING HARDWARE

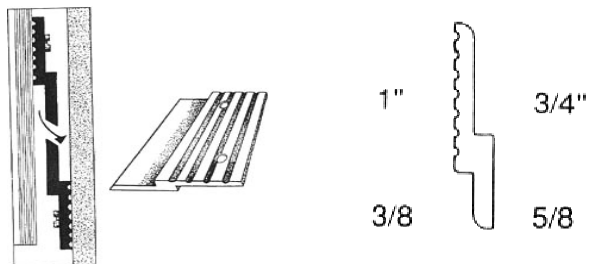

HDPANELRAIL8, **HDPANELRAIL12** use only 1/4" space behind the panel. Lift off space required is 3/8". Aluminum, 8 foot & 12 foot. Overall height is 2-3/8" as designed; 2" if reversed. Sold individually. Drilled on 16" centers.

HDPANELCLIP is 2" long drilled for 2 screws.

JOINERS

These good quality, German made bedrail fasteners have an overall height of 4". Sold individually, with each piece consisting of one male and one female. Order #8 flat head screws separately.

BEDRAILFASTE

Chair Braces, are zinc plated stamped steel, bags of 100, w/o screws.

CS341 1-3/8" x 1-3/8"

CS342 2" x 2"



CORNER BRACES are zinc plated steel, without screws.

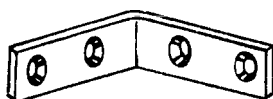

Stock Number	Size	Packaging
ICORNBACE	1"x1"	100/box
2CORNBACE	2"x2"	100/box
8CORNBACE	8"x8"	individually

Aluminum angle - suitable for cinching countertops to walls and other bracing uses. In order to hold costs to a minimum - not anodized, not drilled, not wrapped. But tempered for strength. Stocked in 8 foot lengths. Order stock number



Stock Number	Leg Length	Thickness
ANGLE11/2A1/8	1-1/2"	1/8"
ANGLE1A1/8	1"	1/8"
ANGLE1-1/2A1/16	1-1/2"	1/16"
ANGLE2A1/8	2"	1/8"

Connecting Screws are used to connect two cabinets together. These connecting screws are all steel - as we have experienced cracking of the plastic style screws - and are the heaviest duty we've ever seen, with a whopping diameter of 8mm. Sold in 100's.



8CONNECT38 Adjusts from 1.45-1.80"(1-38-1-7/8")
8CONNECTMALE One required per female

For regular duty applications, we stock 5mm diameter connecting screws. Sold in 100's.



5CONNECT38 Adjusts from 35-38mm
5CONNECT31 Adjusts from 29-32mm
5CONNECTMALE One required per female

MENDING PLATES are zinc plated, sold individually, no screws

Stock Number	Size in Inches
2MENDPLATE	2"
3MENDPLATE	3"
4MENDPLATE	4"
5MENDPLATE	5"
6MENDPLATE	6"
8MENDPLATE	8"

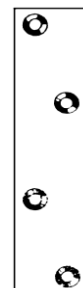

JOINT FASTENERS

Apply an even controlled pressure between joint members that eliminates tendencies to twist and buckle. They maintain a firm, solid joint without glue and permit quick disassembly if required. They are designed for 3/4" material, though of course could be used for thicker material.



KV516/25 (25/bx, complete)
KV516/100 (100/bx, complete)
KV516/64 (extra 7/8" steel drill bit)



The **KV510** is a more economical fastener, easy to install. Provided with 4" bolt, plate measures 5/16" x 5/8" x 1-1/2". Packaged in 100s



CS513 is our best price/value ratio joint fastener. Provided with a 4" bolt, and plates that measure 7/16"x3/16"x1-1/2". Packaged in 100s



JOINING WAFERS, or footballs, are compressed for easy insertion into slots, beechwood for strength, and cross-slashed to insure good glue adhesion. Each is 4mm thick. Lamello brand.



Stock Number	Size
0JOINTPLATE	47 x 15mm
10JOINTPLATE	53 x 19mm
20JOINTPLATE	56 x 23 mm
MIXEDJOINTS	(250 - 0's, 250 - 10's and 500 - 20's)

Manufactured from translucent, environmentally friendly polypropylene, plates for joining man-made materials such as Corian, Avonite, etc. Milky-white in color, same (20 x 55 mm) size as the # 20 plate, these plates serve solely for stabilization purposes and may be glued with the adhesive normally recommended by the solid surface material manufacturer. In boxes of 250. **C20PLATE**



The Lamello Simplex, manufactured from aluminum, and suitable for detachable joining of radiator concealments, shelves, furniture parts, etc. Aluminum parts are identical - when mounting, just reverse placement. Same size (20 x 55mm) as # 20 plates. Easy, precise fitting with aid of the inserting tool. Glue with two-component (epoxy) adhesive. In boxes of 50 pairs. **KDJOINTPLATE KDJOINTTOOL**

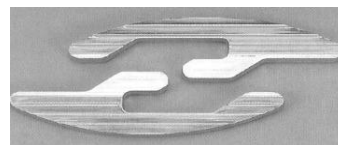

The Lamello K-20 plate is used where clamping of the work piece is not possible - screens, paneling, large work pieces.

- made of high grade red colored POM with smooth finish
- barbed cross-ribs on whole surface for perfect setting
- same size as the #20 plate

Needs no gluing, but may be glued if preferred (common wood glue). 250/box **K20PLATES**

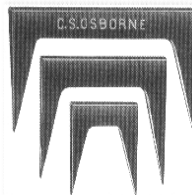
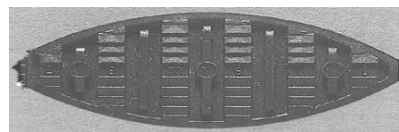

Osborne Pinch Dogs are labor savers and provide a quick way of holding joints together while glue hardens. Easily removed. Use over and over again.

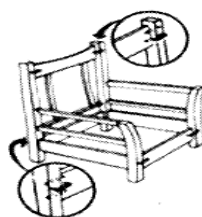

Stock Number	Size
PINCHDOG1	1"
PINCHDOG11/4	1-1/4"
PINCHDOG11/2	1-1/2"
PINCHDOG2	2"
PINCHDOG21/2	2-1/2"
PINCHDOG23/4	2-3/4"
PINCHDOG3	3"
PINCHDOG31/2	3-1/2"

Our screws are the finest obtainable. All are case hardened. All are manufactured from especially strong steel. All have high sheer strength specifications. All are spot checked when they arrive from the manufacturer to insure they meet specifications. All are deep coarse threaded for super holding power. *Stop putting up with screws that sheer off when you torque them, or pull out readily.*



HARDWARE ATTACHMENT SCREWS, phillips head drive, flat head unless otherwise indicated.



<u>Stock No.</u>	<u>Description</u>	<u>Pkg./qty.</u>
3X17PHZP	#3X43/64" Zc plt, pan head	100
3X17PHBRN	#3x43164" Brown, pan head	100
4X5/8BP	#4x5/8" Brass plate, flat	75
4X5/8BPM	#4x5/8" Brass plate, flat	1000
4X5/8NP	#4x5/8" Brite zinc, flat	75
4X5/8NPM	#4x5/8" Brite zinc, flat	1000
5X1/2AB	#5x1/2" Antique brass, flat	100
5X5/8BP	#5 x5/8" brass plate, flat	75
5X5/8NP	#5x5/8 Brite zinc, flat	75
5X5/8OHAB	#5x5/8 Ant. Brass, oval	100
5X5/8NPM	#5x5/8 Zinc plate, flat	1000
5X5/8BPM	#5x5/8 Zinc plate, flat	1000
6X1/2NP	#6x1/2" Brite Zinc, flat	500
6X1/2PHZP	#6x1/2" Zinc Plate, pan	100
6X5/8AB	#6x5/8" Ant. Brass, flat	500
6X5/8NP	#6x5/8" Brite Zinc, flat	500
6X5/8PSSSC	#6x5/8" Stainless, flat	100
6X3/4BP	#6x3/4" Brass plate, flat	75
6X3/4NP	#6X3/4" Brite Zinc, flat	500
6X3/4PHZP	#6x3/4" Brite zinc, pan	75
6X1NP	#6x1" Brite Zinc, flat	500
6X7/8PHZP	#6X1" Brite zinc, pan	75
62PSZC	#6x2" Zinc, Phillips	100
8X3/4PHZPM	#8x3/4" Brite zinc, pan	100
8X3/4SB	#8x3/4", Solid Brass, flat	100
8X3/4ZP	#8x3/4" zinc, flat	100
8X7/8PHZP	#8x7/8" zinc, flat	100
8X11/2PHZP	#8X1 1/2" zinc, pan	100
10X3/4PHZP	#10x3/4", zinc, round	500
12X11/2PHZP	#12x1-1/2" zinc, pan	100
7MMSCREW	7mm Euro screw, pozi drive	100
10MMSCREW	10mm Euro screw, pozi drive	1000
13MMSCREW	13 mm Euro screw, pozi drive	1000

DRYWALL or CONSTRUCTION SCREWS, phillips drive with deep thread and slightly flared head. Black oxide.

<u>Stock No.</u>	<u>Description</u>	<u>Pkg./qty.</u>
81PSBM	#8 x 1", black, flat	1,000
81-1/4PSBM	#8 x 1-1/4", black, flat	1,000
81-1/2PSBM	#8 x 1-1/2", black, flat	1,000
815/8PSBM	#8 x 1-5/8", black, flat	1,000
813/4PSBM	#8x1-3/4", black, flat	1,000
82PSBM	#8 x 2", black, flat	1,000
82-1/2PSBM	#8 X 2-1/2", black, flat	1,000
83PSBM	#8X3,, black, flat	1,000



DRYWALL or. CONSTRUCTION .SCREWS, square drive with deep thread and slightly flared 75 head. Black oxide.

<u>Stock No.</u>	<u>Description</u>	<u>Pkg./qty.</u>
61SSBM	#6x1", black, square	1,000
61-5/8SSBM	#6 x 1-5/8", black, square	1,000
62-1/4SSBM	#6 x 2-1/4", black, square	1,000



Drawer front adjusting screws. Overbore drawer fronts to 5/16"- allows adjustment . Brite zinc, Phillips drive.

81-1/4PWZM	#8x1-1/4", washer head	1,000
81-1/2PWZM	#8x1-1/4", washer head	1,000



SELF COUNTERSINKING, DRYWALL or CONSTRUCTION SCREWS, square drive with deep thread and slightly flared head.

<u>Stock No.</u>	<u>Description</u>	<u>Pkg./qty.</u>
81-5/8SNZM17	#8x1-5/8", zinc	1,000



SELF COUNTERSINKING, DRYWALL or CONSTRUCTION SCREWS, phillips drive with deep thread and slightly flared head. Zinc plated. Sold by pack & in 1000's.

<u>Stock No.</u>	<u>Description</u>	<u>Pkg./qty.</u>
81PNZB17	#8 X 1", zinc	11,000
81-1/4PNZB17	#8 x 1-1/4", zinc, bulk	9,000
81-1/2PNZB17	#8 X 1-1/2", zinc, bulk	7,000
81-5/8PNZB17	#8x 1-5/8", zinc, bulk	5,500
82PNZB17	#8 X 2" zinc bulk	4'000
82-1/2PNZB17	#8 X 2-1/2", zinc, bulk	2,500
83PNZB17	#8 X 3" zinc	2,000



TRUSS HEAD, machine screws, zinc plated, combo slots (phillips + slotted)

Stock No.	Description	Pkg./qty.
M4X22ZP	M4x22mm	100
M4X25ZP	M4x25mm	100
M4X30ZP	M4x30mm	100
M4X38ZP	M4x38mm	100
M4X45ZP	M4x45mm	100
M4X75ZP	M4x75mm	sold ea
8/32X1-1/2	8/32x1-1/2"	100
8/32X1	8/32x1"	100
8/32X1-3/4	truss machine	100
8/32X13/4	break off mach. screw	100
M4X45BREAKOFF	" " "	100
1/43PSZCd	not truss head lead	100

HANGERBOLT, also known as hanger screw or 8/32 machined thread on one end, #6 x 5/8" long wood screw on other end. For installing knobs, etc.

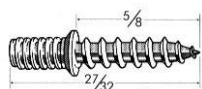

Euro Dia.	USA Equivalent	Driving Bit
3.0	#5	1PHILDRIVE 1SQUAREDIVE
3.5	6	2PHILDRIVE 1SQUAREDIVE
4.0	6	2PHILDRIVE 2SQUAREDIVE
4.5	9	2PHILDRIVE 2SQUAREDIVE
5.0	10	2PHILDRIVE 2SQUAREDIVE
6.0	13	3- not stocked



BITHOLDER 1/4" hex drive, 3" magnetic bit holder



QUICKHOLDER

1/4" hex drive, quick release, 2-1/4" bit holder

Hinged cover caps, sold in bags of 100.

ALMONDCAPS
BLACKCAPS
BROWNCAPS
WHITECAPS

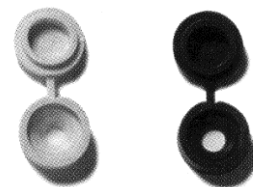

These press in to the head of a screw driven with a #2 phillips driver. 1,000/bg.



8ALMONDCAPS
8BLACKCAPS
8BROWNCAPS
8WHITECAPS
8GREYCAPS

These press in to the head of a screw driven with a #2 square driver. 1,000/bg.

SQALMONDCAPS
SQBLACKCAPS
SQBROWNCAPS
SQWHITECAPS
SQGREYCAPS



FINISHING WASHERS Solid brass, 100/bx.

FINWASH6PB
FINWASH8PB
FINWASH10PB



FINISHING WASHERS Bright zinc plated.
Packaging as shown.

6 washers are for 5 & 6 screws
8 washers are for 6 & 7 screws
10 washers are for 8 & 9 screws

100/box 1000/bx
FINWASH6ZC FINWASH8ZM
FINWASH8ZC FINWASH10ZM
FINWASH10ZC



FINISHING WASHERS, black oxide, for #8 screws. 1000/bx.

FINWASH10BM

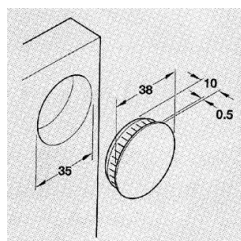

**35WHITECAP**

Trim cap for cup holes 35 mm diameter.

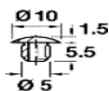
**5MMWHCAPS**

To plug holes and cover screws, we stock the following plugs (oak is mixed red + white):

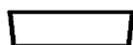

Flat Head Stock #	Diameter in Inches	wood species	Round Head Stock #
FH3/8BIRCH	3/8	birch	RH3/8BIRCH
FH3/8CHERRY	3/8	cherry	RH3/8CHERRY
FH3/8OAK	3/8	oak	RH3/8OAK
FH3/8WALNUT	3/8	walnut	RH3/8WALNUT
FH1/2BIRCH	1/2	birch	RH1/2BIRCH
FH1/2CHERRY	1/2	cherry	RH1/2CHERRY
FH1/2OAK	1/2	oak	RH1/2OAK
FH1/2WALNUT	1/2	walnut	RH1/2WALNUT

DOWEL PINS, plastic, for 8mm holes

180DOWELPIN high quality, impact resistant plastic. Tooth-like grooves guarantee a tight fit even without glue. Dowels holds work pieces together until glue can set (unlike wood dowels which require clamping until glue is set).

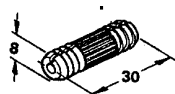

SNAPSCREW self-drilling drywall anchors. Use 8x1-1/2 screws. Industry safe holding is 1/4 of the ultimate load. 100/box

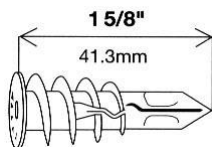

Drywall Thickness

3/8"
1/2"
5/8"

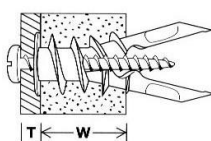

Holds up to

57 lbs
79 lbs
135 lbs

90DOWELPIN to reinforce a 90° connection. Made of nylon to provide some flexibility while insuring strength.

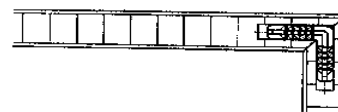

All dowels are beech wood, 1000 bag.

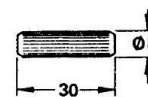
8X30DOWELS**8X35DOWELS****8X40DOWELS**

ZIP IT wallboard anchors. Drive with #2 or #3 phillips driver, use with #8 screws. A unique thread design with knife-like oversize threads achieves unusually high holding power in gypsum wallboard, without sacrificing speed. One size

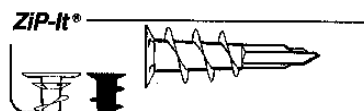

suitable for all thicknesses from 3/8" to 1".

Wallboard Thickness

	3/8"	1/2"	5/8"	3/4"
Tension load #'s	50	65	80	85
Shear load #'s	60	70	100	100

The values listed are ultimate load capacities which should be reduced by a safety factor of 4 or greater to determine the allowable working load.

Stock Number

Packing

Metal	ZIPITM	100
Plastic	ZIPITP	100